

Physical Address:

Auburn City Hall Annex, 2nd Floor
1 E Main St

Mailing Address:

25 W Main St
Auburn, WA 98001-4998

Webpage & Application Submittal:

www.auburnwa.gov
mybuildingpermit.com

Phone and Email:

Phone: (253) 931-3090

1. Place building paper or house wrap under sill flashing. Sill flashing must overlap building paper or house wrap 2" minimum.

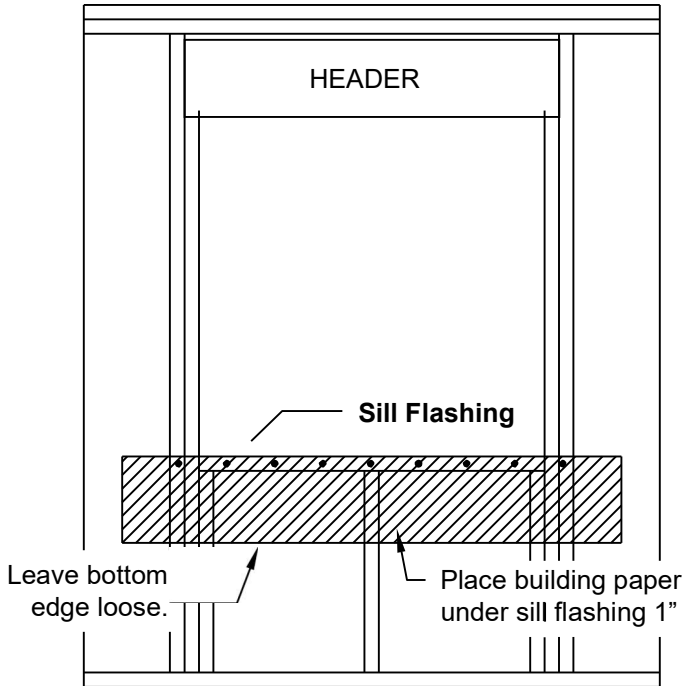

2. Place building paper or house wrap over jamb flashing. Building paper or house wrap must overlap jamb flashing 6" minimum.

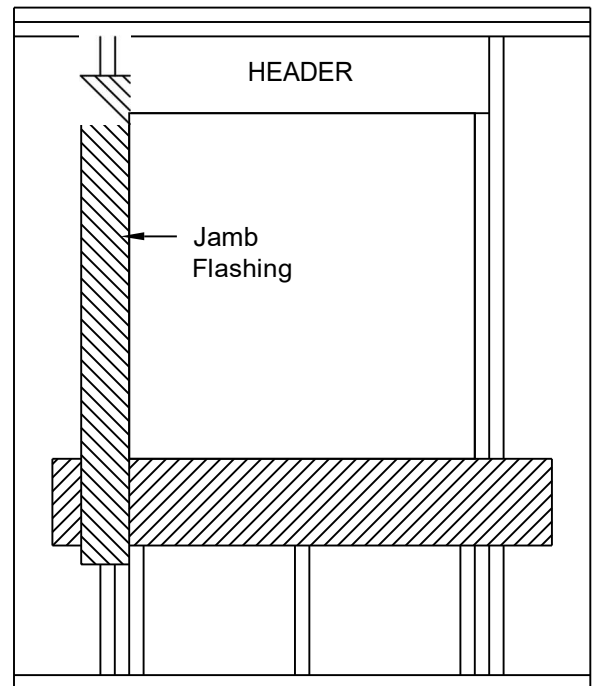

3. Install window flanges over sill and jamb flashings. Seal window per manufacturer's recommendations.

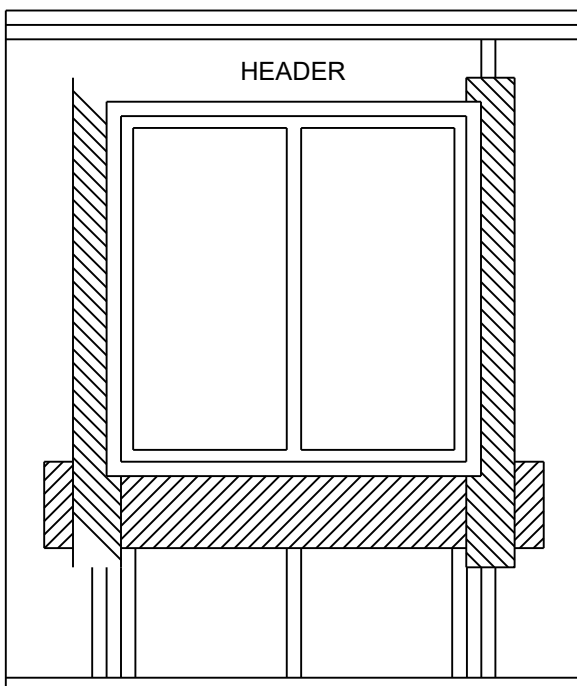

4. Install head flashing over window flange. Extend 1" beyond outer edge of jamb flashings.

